



LEDBeam
150™
FW

7 X 40W
RGBW
MULTICHIPS

18 BIT
DIMMER

EXTREMELY
FAST
PAN
TILT
MOVEMENT

Accessories

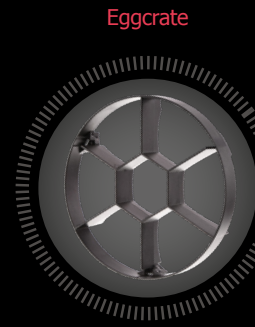

Eggcrate



Diffusion filter 2° (for LEDBeam 150)

Packaging

Single Top Loader Case



375 x 285 x 575 mm
(14.8" x 11.2" x 22.6")

Quad Top Loader Case



600 x 600 x 595 mm
(23.6" x 23.6" x 23.4")

Eight-Pack Top Loader Case



1050 x 600 x 595 mm
(41.3" x 23.6" x 23.4")

Exterior dimensions



www.robe.cz



Head office: ROBE lighting s. r. o. | Hážovice 2090 | 756 61 Rožnov pod Radhoštěm | Czech Republic
Factory: ROBE lighting s. r. o. | Palackého 416 | 757 01 Valašské Meziříčí | Czech Republic
Tel.: +420 571 751 500 | Fax: +420 571 751 515 | E-mail: robe@robe.cz

October 2019 © ROBE lighting s. r. o. All specifications subject to change without notice. Patents pending.



PERFECT
COLOUR
MIXING

ZOOM
RANGE 3.8°-60°

TRUE
WHITES

LEDBeam
150™

LEDBeam

LEDBeam 150™/150™ FW Innovative technology LEDBeam 150™/150™ FW Product diagrams

The best things come in small packages, now with zoom included. LEDBeam 150 is the answer with fast sweeping beams and a wide far-reaching quality wash in compact housing.

The spectacular zoom range of 3.8° to 60° uses an eminent custom-designed optical system, now equipped with Robe's innovative lens coating technology which brings benefits such as bright and clear lenses, no scratches or marks, higher light output and longer intervals between cleaning. The unique LEDBeam 150 FW offers Fresnel-Wash type of light output for even smooth edges and better color homogenization.

Attractive colorful chases and smooth transitions are powered by a cluster of high power multichip 40W RGBW LEDs. A highly optimized motorised control produces speedy pan and tilt movement. Besides intense strobing capabilities, both LEDBeam 150 and LEDBeam 150 FW also offer gentle 18-bit dimming, including Tungsten lamp effects.

Source

- Light source type: 7 x 40W RGBW multichips
- LED life Expectancy: min. 20.000 hours
- Optical lumen maintenance: 70% @ 20.000 hours

Optical System

- Robe's proprietary optical design
- Innovative lens coating technology (Patent pending)
- High - efficiency zoom optical system, ratio 15.5: 1
- Zoom range: 3.8°-60°
- Diffusion filter imbedded (for LEDBeam 150 FW)
- Fixture total lumen output:
LEDBeam 150: 2.842 lm
LEDBeam 150 FW: 2.288 lm
- Brightness:
LEDBeam 150: 12.200 lx @5m
LEDBeam 150 FW: 8.190 lx @5m

Dynamic Effects

- Colour mixing mode RGBW or CMY
- Variable CTO: 2.700K-8.000K
- Virtual Colour Wheel: with 66 preset swatches
- Tungsten lamp effect at whites: 2.700K and 3.200K (red shift and thermal delay)
- Motorized zoom
- Pre-programmed random strobe & pulse effects
- High resolution electronic dimming: 0-100 %

Control and programming

- Setting & Addressing: two-row LCD display & 4 control buttons, stand-alone operation with 3 editable programs (each up to 40 steps)
- Protocols: USITT DMX-512, RDM
- Wireless CRMX™ technology from Lumen Radio (on request)
- DMX Protocol modes: 2
- Control channels: 22, 16
- Pan/Tilt resolution: 8 or 16 bit
- RGBW / CMY: 8 or 16 bit
- Zoom: 8 or 16 bit
- Dimmer: 8 or 16 bit (internal 18 bit)

Movement

- Pan movement: 450°
- Tilt movement: 228°
- Movement control: Standard and Speed
- Controllable speed of Pan/Tilt movement
- Automatic Pan/Tilt position correction

Thermal Specification

- Maximum ambient temperature: 45 °C (113 °F)
- Maximum surface temperature: 80 °C (176 °F)
- Minimum operating temperature: -5 °C (23 °F)

Electrical Specification and Connections

- Power supply: Electronic auto-ranging
- Input voltage range: 100-240 V, 50/60 Hz
- Power consumption: Max. 220 W
- Power in/out connector: Neutrik powerCON in/out
- DMX and RDM data in/out: Locking 5-pin XLR

Approvals

- CE Compliant
- cETLus Compliant

Mechanical specification

- Height: 337 mm (13.27")
- Width: 244 mm (9.6")
- Depth: 149 mm (5.87")
- Weight: 5.7 kg (12.6 lbs)

Included Items

- User Manual
- Omega Adaptor CL-regular

Rigging

- Mounting points: 1 pair of 1/4-turn locks
- 1 x Omega adaptor with 1/4-turn quick locks
- Universal operating position
- Safety cable attachment point

Accessories

- Diffusion filter 2° (for LEDBeam 150): 10980423
- Wireless DMX external module: 10980127
- EggCrate: 10980346
- Safety wire 35 kg: 99011963
- Mains Cable powerCON In/Schuko 2 m: 13051724
- Mains Cable powerCON In/CEE 16A 2 m: 13051725
- Mains Cable powerCON In/US 2 m: 13051726
- Mains Cable powerCON In/open ended 2 m: 13051731
- Daisy Chain powerCON In/Out EU 2 m: 13051727
- Daisy Chain powerCON In/Out US 2 m: 13051728
- Single Top Loader Case: 10120214
- Quad Top Loader Case: 10120215
- Eight Pack Top Loader Case: 10120216
- Foam Shell: 20020300

Legal

- LEDBeam 150™ and LEDBeam 150™ FW are the trademarks of Robe lighting s.r.o.
- LEDBeam 150™ and LEDBeam 150™ FW are patented by Robe lighting s.r.o. and protected by one or more pending or issued patents



LED colours

LEDBeam 150 is able to produce 4300 from pastel to saturated colours.



Optical System

Incorporating sophisticated custom-designed optical system combined with optional eggcrate for precise control of the light beam.

Lens Coating Technology

The innovative lens coating technology protects soft plastic lenses against „surface scattering“ even when scrubbed repeatedly. Anti-static properties prolong the time period before the lenses will collect dust and create white maps on the lens surface. The new coating brings countless benefits including longer intervals between cleaning, bright and clear lenses, no scratches or marks, and higher light output. (Patent pending)

Zoom Range

Spectacular zoom range of 3.8° to 60° offers fast sweeping beams and a wide excellent quality wash.

True White Colours

Spotless colormixing of specially calibrated LEDs together with predefined values on a Virtual Colour wheel channel allow quick direct calling of exact white hues of 2.700K, 3.200K, 4.200K, 5.600K and 8.000K.



Tungsten effect

In the Halogen lamp mode predefined for White Halogen 2.700K and 3.200K, the Dimmer channel initiates halogen lamp-like behaviour (red effect and thermal delay) during dimming.

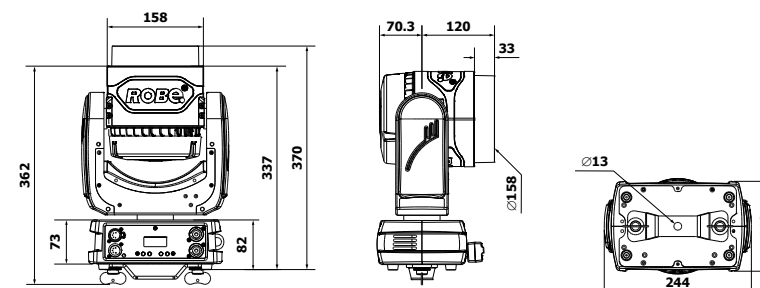

LEDBeam 150™

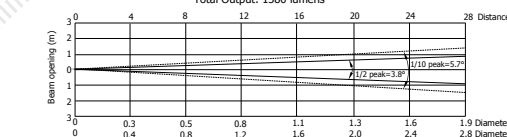

Distance (m)	4	5	8	12	16	20	24	28
Red	700/36	210/24	58/15	43/14	26/13	15/15	10/10	6/8
Green	700/36	210/24	58/15	43/14	26/13	15/15	10/10	6/8
Blue	700/36	210/24	58/15	43/14	26/13	15/15	10/10	6/8
White	950/188	210/24	230/22	180/18	130/16	90/15	60/15	40/18
R+G+B+W	1000/171	200/11	400/4	210/11	110/11	70/7	50/5	30/3

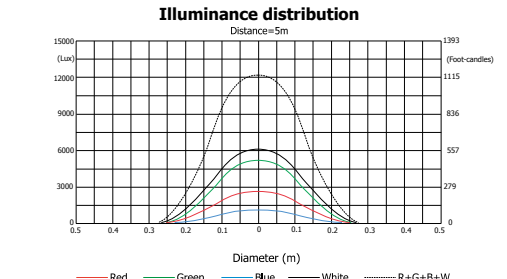

LEDBeam 150™ FW

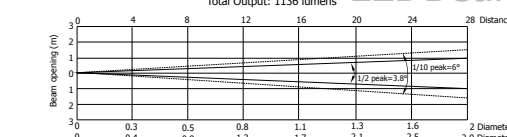

Distance (m)	4	5	8	12	16	20	24	28
Red	200/24	180/15	60/12	40/12	25/12	15/12	10/12	6/12
Green	200/24	180/15	60/12	40/12	25/12	15/12	10/12	6/12
Blue	200/24	180/15	60/12	40/12	25/12	15/12	10/12	6/12
White	220/24	180/15	120/12	80/12	50/12	35/12	25/12	15/12
R+G+B+W	120/11	180/11	200/12	140/12	100/12	70/12	50/12	30/12

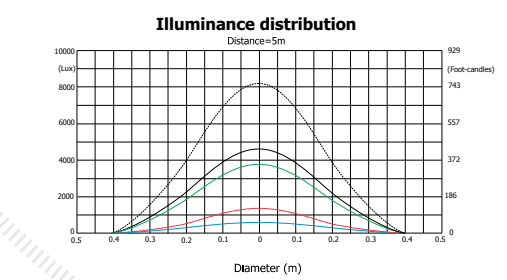

LEDBeam 150™

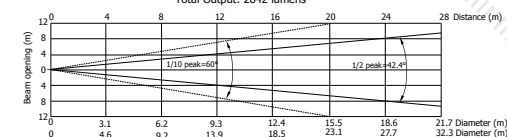

Distance (m)	4	5	8	12	16	20	24	28
Red	87/5	56/5	20/2	10/8	6/5	4/3	2/2	2/2
Green	168/10	138/10	42/4	28/4	18/4	12/4	8/4	5/4
Blue	168/10	138/10	42/4	28/4	18/4	12/4	8/4	5/4
White	950/188	210/24	230/22	180/18	130/16	90/15	60/15	40/18
R+G+B+W	42/7/29	28/2/25	10/15	4/4	2/2/4	1/1/2	1/1	1/1

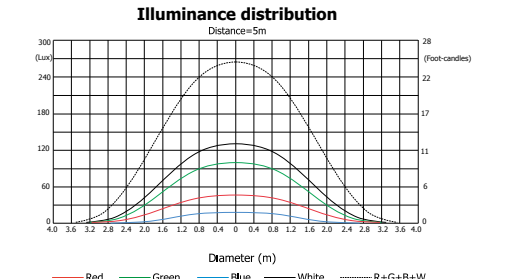

LEDBeam 150™ FW

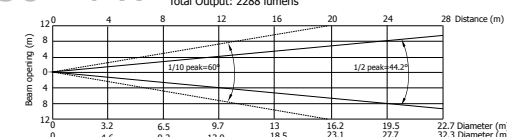

Distance (m)	4	5	8	12	16	20	24	28
Red	73/6	47/4	18/1	8/0.8	5/0.4	3/0.3	2/0.2	1/0.1
Green	140/4	9/6	37/4	17/1.5	9/1	6/0.6	4/0.4	3/0.3
Blue	140/4	9/6	37/4	17/1.5	9/1	6/0.6	4/0.4	3/0.3
White	202/17	130/11	60/6	2/0.2	1/0.1	0.6/0.1	0.4/0.1	0.4/0.1
R+G+B+W	33/3	23/20	9/8	3/3	2/2	1/1	1/1	1/1

